



MODEL: NSCS-SERIES

Capacity: 10 - 100 Ton

Stroke: 38 - 62 mm

Max. Working Pressure: 700 bar / 10,000 psi

- All cylinders are single acting with spring return.
- Pistons hard chromed.
- Cylinders inside roll-polished.
- Cylinders outside blasted with black nitriding finish.

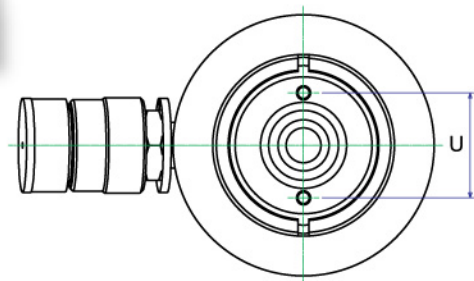

Hand / Foot Pumps Page 19-30



High Pressure Accessories Page 73-79

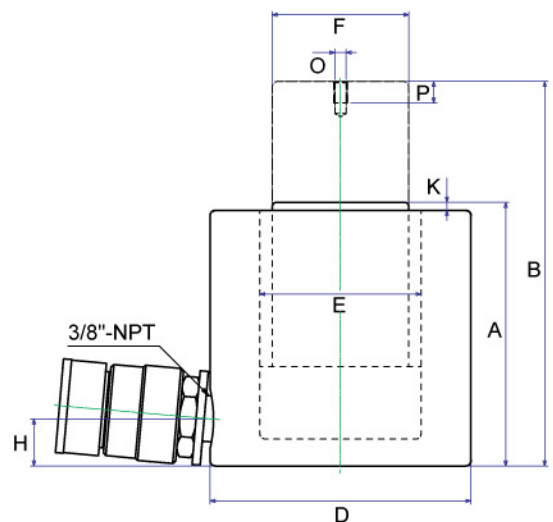

NSCS-SERIES, COMPACT CYLINDERS

Model	Capacity Ton	Stroke (mm)	Oil Cap (cm ³)	A		C	D	E	F	H	K	V	G	O	P	U	L	M	Weight (kgs)
				HEIGHT(mm)															
				RETRACTED	EXTENDED														
NSCS101	10	38	55.0	88	126	—	78	42.8	38	17.5	5	—	—	M4	8	26	—	—	4.1
NSCS201	20	45	127.0	98	143	—	97	60	50.8	17.5	3	—	—	M5	9	39	—	—	5
NSCS302	30	62	274.0	117	179	—	107	75	63.5	19	3	—	—	M5	8	39	—	—	6.8
NSCS502	50	60.5	429.0	127	187.5	—	127	95	70	19	2	—	—	M5	8	39	—	—	10.9
NSCS1002	100	58	830.0	146.5	204.5	—	165	135	92	25	1.5	—	—	M8	10	55	—	—	22.7